

# Valley Green Grow Facility

Charlton, MA

## Lighting System

Pole / Fixture Summary						
Pole ID	Pole Height	Mtg Height	Fixture Qty	Luminaire Type	Load	Circuit
P1-P8, P12, P14-P61	25'	25'	1	3000K - 70CRI	0.00 kW	A
P9-P11, P13	25'	25'	2	3000K - 70CRI	0.00 kW	A
<b>61</b>			<b>65</b>		<b>0.00 kW</b>	

Circuit Summary			
Circuit	Description	Load	Fixture Qty
A		8.45 kW	65

Fixture Type Summary							
Type	Source	Wattage	Lumens	L90	L80	L70	Quantity
3000K - 70CRI	3000K - 70CRI	130W	12,649	--	--	--	65

## Light Level Summary

Calculation Grid Summary								
Grid Name	Calculation Metric	Illumination					Circuits	Fixture Qty
		Ave	Min	Max	Max/Min	Ave/Min		
Drive / Parking Lot	Horizontal Illuminance	1.78	0	7	2348.80		A	65
Spill	Horizontal Illuminance	0.04	0	4	0.00		A	65
Spill	Max Vert Illuminance (by Light Bank)	0.07	0	5	0.00		A	65

## From Hometown to Professional

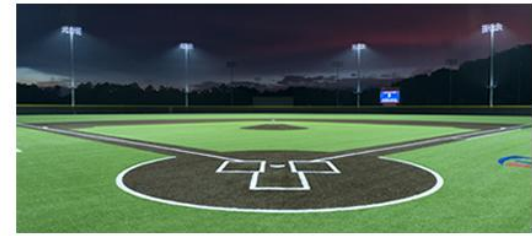

Not to be reproduced in whole or part without the written consent of Musco Sports Lighting, LLC. ©1981, 2018 Musco Sports Lighting, LLC.

EQUIPMENT LIST FOR AREAS SHOWN									
QTY	LOCATION	Pole		Luminaires				THIS GRID	OTHER GRIDS
		SIZE	GRADE ELEVATION	LUMINAIRE TYPE	QTY / POLE				
1	P1	25'	-33'	CREE OSQ 3000K (3ME)	1	1	0		
1	P2	25'	-23'	CREE OSQ 3000K (3ME)	1	1	0		
2	P3, P17	25'	-16'	CREE OSQ 3000K (3ME)	1	1	0		
1	P4	25'	-11'	CREE OSQ 3000K (3ME)	1	1	0		
2	P5, P35	25'	1'	CREE OSQ 3000K (3ME)	1	1	0		
1	P6	25'	11'	CREE OSQ 3000K (3ME)	1	1	0		
2	P7, P24	25'	21'	CREE OSQ 3000K (3ME)	1	1	0		
2	P8, P47	25'	27'	CREE OSQ 3000K (4ME)	1	1	0		
1	P9	25'	33'	CREE OSQ 3000K (4ME)	2	2	0		
1	P10	25'	27'	CREE OSQ 3000K (4ME)	2	2	0		
1	P11	25'	19'	CREE OSQ 3000K (4ME)	2	2	0		
1	P12	25'	9'	CREE OSQ 3000K (4ME)	1	1	0		
1	P13	25'	8'	CREE OSQ 3000K (4ME)	2	2	0		
1	P14	25'	6'	CREE OSQ 3000K (3ME)	1	1	0		
1	P15	25'	-3'	CREE OSQ 3000K (3ME)	1	1	0		
1	P16	25'	-19'	CREE OSQ 3000K (3ME)	1	1	0		
1	P18	25'	-10'	CREE OSQ 3000K (3ME)	1	1	0		
2	P19, P31	25'	-1'	CREE OSQ 3000K (3ME)	1	1	0		
2	P20, P30	25'	3'	CREE OSQ 3000K (3ME)	1	1	0		
2	P21, P23	25'	15'	CREE OSQ 3000K (3ME)	1	1	0		
1	P22	25'	17'	CREE OSQ 3000K (3ME)	1	1	0		
2	P25, P57	25'	24'	CREE OSQ 3000K (3ME)	1	1	0		
3	P26-P27 P58	25'	27'	CREE OSQ 3000K (3ME)	1	1	0		
2	P28, P50	25'	23'	CREE OSQ 3000K (3ME)	1	1	0		
1	P29	25'	12'	CREE OSQ 3000K (3ME)	1	1	0		
3	P32-P34	25'	-5'	CREE OSQ 3000K (3ME)	1	1	0		
1	P36	25'	14'	CREE OSQ 3000K (3ME)	1	1	0		
1	P37	25'	22'	CREE OSQ 3000K (3ME)	1	1	0		
1	P38	25'	28'	CREE OSQ 3000K (3ME)	1	1	0		
1	P39	25'	26'	CREE OSQ 3000K (3ME)	1	1	0		
1	P40	25'	19'	CREE OSQ 3000K (3ME)	1	1	0		
1	P41	25'	11'	CREE OSQ 3000K (4ME)	1	1	0		
1	P42	25'	7'	CREE OSQ 3000K (4ME)	1	1	0		
1	P43	25'	20'	CREE OSQ 3000K (4ME)	1	1	0		
1	P44	25'	29'	CREE OSQ 3000K (4ME)	1	1	0		
1	P45	25'	33'	CREE OSQ 3000K (4ME)	1	1	0		
1	P46	25'	32'	CREE OSQ 3000K (4ME)	1	1	0		
2	P48-P49	25'	17'	CREE OSQ 3000K (4ME)	1	1	0		
1	P51	25'	38'	CREE OSQ 3000K (4ME)	1	1	0		
1	P52	25'	49'	CREE OSQ 3000K (4ME)	1	1	0		
1	P53	25'	50'	CREE OSQ 3000K (4ME)	1	1	0		
1	P54	25'	46'	CREE OSQ 3000K (4ME)	1	1	0		
1	P55	25'	37'	CREE OSQ 3000K (4ME)	1	1	0		
1	P56	25'	25'	CREE OSQ 3000K (3ME)	1	1	0		
1	P59	25'	32'	CREE OSQ 3000K (3ME)	1	1	0		
1	P60	25'	39'	CREE OSQ 3000K (3ME)	1	1	0		
1	P61	25'	31'	CREE OSQ 3000K (4ME)	1	1	0		
61	TOTALS				65	65	0		

# Valley Green Grow Facility

GRID SUMMARY	
Name:	Drive / Parking Lot
Size:	0' x 0'
Spacing:	20.0' x 20.0'
Height:	-0.9' above grade

ILLUMINATION SUMMARY	
MAINTAINED HORIZONTAL FOOTCANDLES	
Entire Grid	
Scan Average:	1.78
Maximum:	7
Minimum:	0
Avg / Min:	626.59
Max / Min:	2348.80
UG (adjacent pts):	0.00
CU:	0.59
No. of Points:	673

LUMINAIRE INFORMATION	
Color / CRI:	3000K - 70CRI
Luminaire Output:	12,649 / 12,312 lumens
No. of Luminaires:	65
Avg Load:	8.45 kW
Max Load:	0.0 kW

**Guaranteed Performance:** The ILLUMINATION described above is guaranteed per your Musco Warranty document and includes a 0.95 dirt depreciation factor.

**Field Measurements:** Individual field measurements may vary from computer-calculated predictions and should be taken in accordance with IESNA RP-6-15.

**Electrical System Requirements:** Refer to Amperage Draw Chart and/or the "Musco Control System Summary" for electrical sizing.

**Installation Requirements:** Results assume ± 3% nominal voltage at line side of the driver and structures located within 3 feet (1m) of design locations.



Pole location(s) + dimensions are relative to 0,0 reference point(s) ⊗



Not to be reproduced in whole or part without the written consent of Musco Sports Lighting, LLC. ©1981, 2018 Musco Sports Lighting, LLC.

## ILLUMINATION SUMMARY

**EQUIPMENT LIST FOR AREAS SHOWN**

QTY	LOCATION	POLE SIZE	GRADE ELEVATION	MOUNTING HEIGHT	Luminaires		QTY / POLE	THIS GRID	OTHER GRIDS
					LUMINAIRE TYPE	QTY / POLE			
1	P1	25'	-33'	2'	CREE OSQ 3000K (3ME)	1	1	0	
1	P2	25'	-23'	2'	CREE OSQ 3000K (3ME)	1	1	0	
2	P3, P17	25'	-16'	9'	CREE OSQ 3000K (3ME)	1	1	0	
1	P4	25'	-11'	14'	CREE OSQ 3000K (3ME)	1	1	0	
2	P5, P35	25'	1'	26'	CREE OSQ 3000K (3ME)	1	1	0	
1	P6	25'	11'	36'	CREE OSQ 3000K (3ME)	1	1	0	
2	P7, P24	25'	21'	46'	CREE OSQ 3000K (3ME)	1	1	0	
2	P8, P47	25'	27'	52'	CREE OSQ 3000K (4ME)	1	1	0	
1	P9	25'	33'	58'	CREE OSQ 3000K (4ME)	2	2	0	
1	P10	25'	27'	52'	CREE OSQ 3000K (4ME)	2	2	0	
1	P11	25'	19'	44'	CREE OSQ 3000K (4ME)	2	2	0	
1	P12	25'	9'	34'	CREE OSQ 3000K (4ME)	1	1	0	
1	P13	25'	8'	33'	CREE OSQ 3000K (4ME)	2	2	0	
1	P14	25'	6'	31'	CREE OSQ 3000K (3ME)	1	1	0	
1	P15	25'	-3'	22'	CREE OSQ 3000K (3ME)	1	1	0	
1	P16	25'	-19'	6'	CREE OSQ 3000K (3ME)	1	1	0	
1	P18	25'	-10'	15'	CREE OSQ 3000K (3ME)	1	1	0	
2	P19, P31	25'	-1'	24'	CREE OSQ 3000K (3ME)	1	1	0	
2	P20, P30	25'	3'	28'	CREE OSQ 3000K (3ME)	1	1	0	
2	P21, P23	25'	15'	40'	CREE OSQ 3000K (3ME)	1	1	0	
1	P22	25'	17'	42'	CREE OSQ 3000K (3ME)	1	1	0	
2	P25, P57	25'	24'	49'	CREE OSQ 3000K (3ME)	1	1	0	
3	P26-P27 P58	25'	27'	52'	CREE OSQ 3000K (3ME)	1	1	0	
2	P28, P50	25'	23'	48'	CREE OSQ 3000K (3ME)	1	1	0	
1	P29	25'	12'	37'	CREE OSQ 3000K (3ME)	1	1	0	
3	P32-P34	25'	-5'	20'	CREE OSQ 3000K (3ME)	1	1	0	
1	P36	25'	14'	39'	CREE OSQ 3000K (3ME)	1	1	0	
1	P37	25'	22'	47'	CREE OSQ 3000K (3ME)	1	1	0	
1	P38	25'	28'	53'	CREE OSQ 3000K (3ME)	1	1	0	
1	P39	25'	26'	51'	CREE OSQ 3000K (3ME)	1	1	0	
1	P40	25'	19'	44'	CREE OSQ 3000K (3ME)	1	1	0	
1	P41	25'	11'	36'	CREE OSQ 3000K (4ME)	1	1	0	
1	P42	25'	7'	32'	CREE OSQ 3000K (4ME)	1	1	0	
1	P43	25'	20'	45'	CREE OSQ 3000K (4ME)	1	1	0	
1	P44	25'	29'	54'	CREE OSQ 3000K (4ME)	1	1	0	
1	P45	25'	33'	58'	CREE OSQ 3000K (4ME)	1	1	0	
1	P46	25'	32'	57'	CREE OSQ 3000K (4ME)	1	1	0	
2	P48-P49	25'	17'	42'	CREE OSQ 3000K (4ME)	1	1	0	
1	P51	25'	38'	63'	CREE OSQ 3000K (4ME)	1	1	0	
1	P52	25'	49'	74'	CREE OSQ 3000K (4ME)	1	1	0	
1	P53	25'	50'	75'	CREE OSQ 3000K (4ME)	1	1	0	
1	P54	25'	46'	71'	CREE OSQ 3000K (4ME)	1	1	0	
1	P55	25'	37'	62'	CREE OSQ 3000K (4ME)	1	1	0	
1	P56	25'	25'	50'	CREE OSQ 3000K (3ME)	1	1	0	
1	P59	25'	32'	57'	CREE OSQ 3000K (3ME)	1	1	0	
1	P60	25'	39'	64'	CREE OSQ 3000K (3ME)	1	1	0	
1	P61	25'	31'	56'	CREE OSQ 3000K (4ME)	1	1	0	
61	TOTALS					65	65	0	

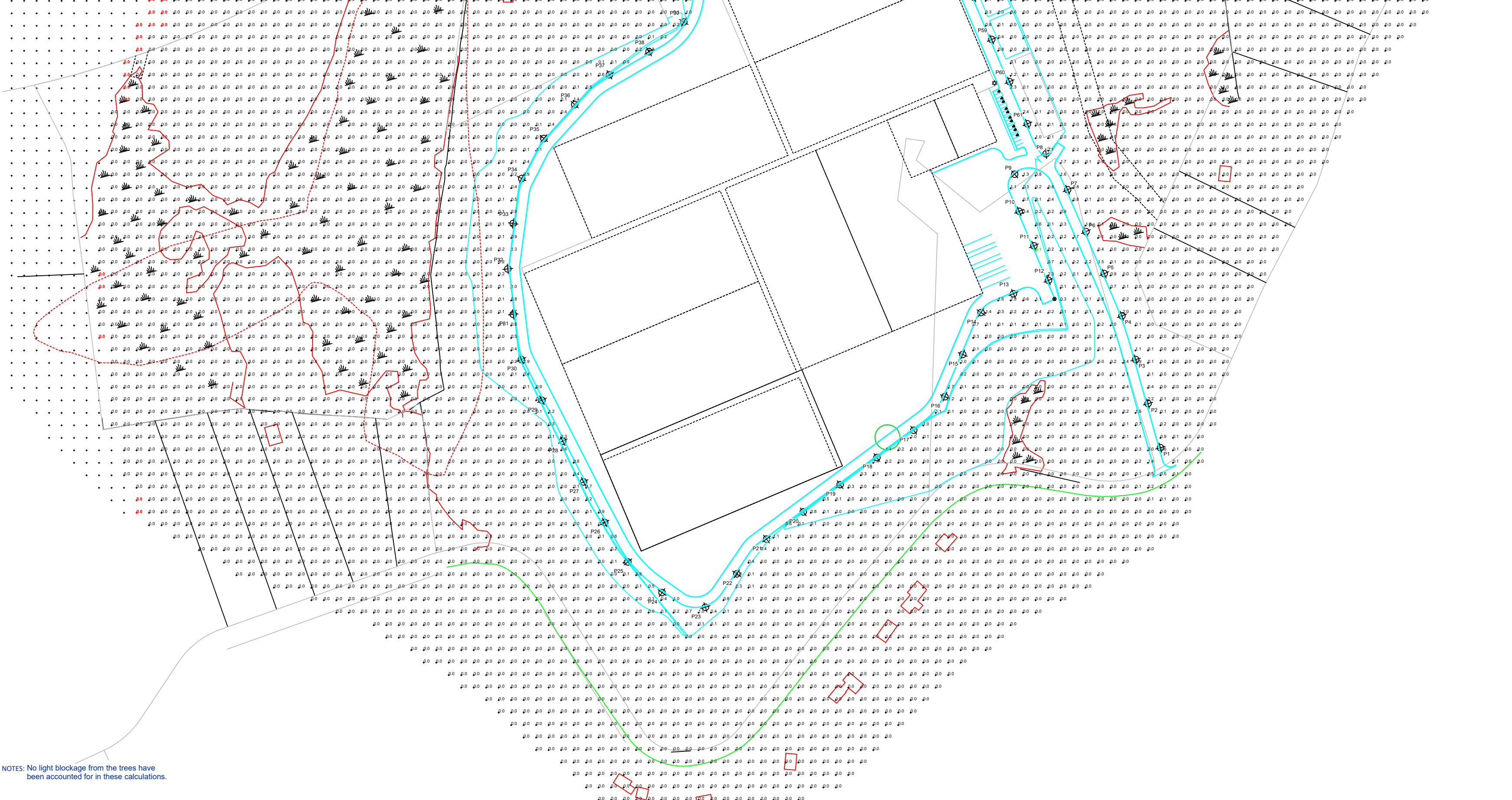

NOTES: No light blockage from the trees have been accounted for in these calculations.



ENGINEERED DESIGN By: Nathan Chizek • File #194201A • 20-Aug-18

**Valley Green Grow Facility**  
Charlton, MA

GRID SUMMARY	
Name:	Spill
Spacing:	30.0' x 30.0'
Height:	-34.8' above grade

ILLUMINATION SUMMARY	
MAINTAINED HORIZONTAL FOOTCANDELS	
Entire Grid	
Scan Average:	0.04
Maximum:	4
Minimum:	0
Avg / Min:	-
Max / Min:	-
UG (adjacent pts):	0.00
CU:	0.25
No. of Points:	6107

LUMINAIRE INFORMATION	
Color / CRI:	3000K - 70CRI
Luminaire Output:	12,649 / 12,312 lumens
No. of Luminaires:	65
Avg Load:	8.45 kW
Max Load:	0.0 kW

**Guaranteed Performance:** The ILLUMINATION described above is guaranteed per your Musco Warranty document and includes a 0.95 dirt depreciation factor.

**Field Measurements:** Individual field measurements may vary from computer-calculated predictions and should be taken in accordance with IESNA RP-6-15.

**Electrical System Requirements:** Refer to Amperage Draw Chart and/or the "Musco Control System Summary" for electrical sizing.

**Installation Requirements:** Results assume ± 3% nominal voltage at line side of the driver and structures located within 3 feet (1m) of design locations.



Not to be reproduced in whole or part without the written consent of Musco Sports Lighting, LLC. ©1981, 2018 Musco Sports Lighting, LLC.

**ILLUMINATION SUMMARY**

**EQUIPMENT LIST FOR AREAS SHOWN**

QTY	LOCATION	POLE	GRADE ELEVATION	MOUNTING HEIGHT	Luminaires		QTY / POLE	THIS GRID	OTHER GRIDS
					SIZE	LUMINAIRE TYPE			
1	P1	25'	-33'	2'	CREE OSQ 3000K (3ME)	1	1	0	
1	P2	25'	-23'	2'	CREE OSQ 3000K (3ME)	1	1	0	
2	P3, P17	25'	-16'	9'	CREE OSQ 3000K (3ME)	1	1	0	
1	P4	25'	-11'	14'	CREE OSQ 3000K (3ME)	1	1	0	
2	P5, P35	25'	1'	26'	CREE OSQ 3000K (3ME)	1	1	0	
1	P6	25'	11'	36'	CREE OSQ 3000K (3ME)	1	1	0	
2	P7, P24	25'	21'	46'	CREE OSQ 3000K (3ME)	1	1	0	
2	P8, P47	25'	27'	52'	CREE OSQ 3000K (4ME)	1	1	0	
1	P9	25'	33'	58'	CREE OSQ 3000K (4ME)	2	2	0	
1	P10	25'	27'	52'	CREE OSQ 3000K (4ME)	2	2	0	
1	P11	25'	19'	44'	CREE OSQ 3000K (4ME)	2	2	0	
1	P12	25'	9'	34'	CREE OSQ 3000K (4ME)	1	1	0	
1	P13	25'	8'	33'	CREE OSQ 3000K (4ME)	2	2	0	
1	P14	25'	6'	31'	CREE OSQ 3000K (3ME)	1	1	0	
1	P15	25'	-3'	22'	CREE OSQ 3000K (3ME)	1	1	0	
1	P16	25'	-19'	6'	CREE OSQ 3000K (3ME)	1	1	0	
1	P18	25'	-10'	15'	CREE OSQ 3000K (3ME)	1	1	0	
2	P19, P31	25'	-1'	24'	CREE OSQ 3000K (3ME)	1	1	0	
2	P20, P30	25'	3'	28'	CREE OSQ 3000K (3ME)	1	1	0	
2	P21, P23	25'	15'	40'	CREE OSQ 3000K (3ME)	1	1	0	
1	P22	25'	17'	42'	CREE OSQ 3000K (3ME)	1	1	0	
2	P25, P57	25'	24'	49'	CREE OSQ 3000K (3ME)	1	1	0	
3	P26-P27 P58	25'	27'	52'	CREE OSQ 3000K (3ME)	1	1	0	
2	P28, P50	25'	23'	48'	CREE OSQ 3000K (3ME)	1	1	0	
1	P29	25'	12'	37'	CREE OSQ 3000K (3ME)	1	1	0	
3	P32-P34	25'	-5'	20'	CREE OSQ 3000K (3ME)	1	1	0	
1	P36	25'	14'	39'	CREE OSQ 3000K (3ME)	1	1	0	
1	P37	25'	22'	47'	CREE OSQ 3000K (3ME)	1	1	0	
1	P38	25'	28'	53'	CREE OSQ 3000K (3ME)	1	1	0	
1	P39	25'	26'	51'	CREE OSQ 3000K (3ME)	1	1	0	
1	P40	25'	19'	44'	CREE OSQ 3000K (3ME)	1	1	0	
1	P41	25'	11'	36'	CREE OSQ 3000K (4ME)	1	1	0	
1	P42	25'	7'	32'	CREE OSQ 3000K (4ME)	1	1	0	
1	P43	25'	20'	45'	CREE OSQ 3000K (4ME)	1	1	0	
1	P44	25'	29'	54'	CREE OSQ 3000K (4ME)	1	1	0	
1	P45	25'	33'	58'	CREE OSQ 3000K (4ME)	1	1	0	
1	P46	25'	32'	57'	CREE OSQ 3000K (4ME)	1	1	0	
2	P48-P49	25'	17'	42'	CREE OSQ 3000K (4ME)	1	1	0	
1	P51	25'	38'	63'	CREE OSQ 3000K (4ME)	1	1	0	
1	P52	25'	49'	74'	CREE OSQ 3000K (4ME)	1	1	0	
1	P53	25'	50'	75'	CREE OSQ 3000K (4ME)	1	1	0	
1	P54	25'	46'	71'	CREE OSQ 3000K (4ME)	1	1	0	
1	P55	25'	37'	62'	CREE OSQ 3000K (4ME)	1	1	0	
1	P56	25'	25'	50'	CREE OSQ 3000K (3ME)	1	1	0	
1	P59	25'	32'	57'	CREE OSQ 3000K (3ME)	1	1	0	
1	P60	25'	39'	64'	CREE OSQ 3000K (3ME)	1	1	0	
1	P61	25'	31'	56'	CREE OSQ 3000K (4ME)	1	1	0	
61					TOTALS	65	65	0	

**Valley Green Grow Facility**  
Charlton, MA

GRID SUMMARY	
Name:	Spill
Spacing:	30.0' x 30.0'
Height:	-34.8' above grade

ILLUMINATION SUMMARY	
MAINTAINED MAX VERTICAL FOOTCANDLES	
Entire Grid	
Scan Average:	0.07
Maximum:	5
Minimum:	0
Avg / Min:	-
Max / Min:	-
UG (adjacent pts):	0.00
CU:	0.25
No. of Points:	6107

LUMINAIRE INFORMATION	
Color / CRI:	3000K - 70CRI
Luminaire Output:	12,649 / 12,312 lumens
No. of Luminaires:	65
Avg Load:	8.45 kW
Max Load:	0.0 kW

**Guaranteed Performance:** The ILLUMINATION described above is guaranteed per your Musco Warranty document and includes a 0.95 dirt depreciation factor.

**Field Measurements:** Individual field measurements may vary from computer-calculated predictions and should be taken in accordance with IESNA RP-6-15.

**Electrical System Requirements:** Refer to Amperage Draw Chart and/or the "Musco Control System Summary" for electrical sizing.

**Installation Requirements:** Results assume ± 3% nominal voltage at line side of the driver and structures located within 3 feet (1m) of design locations.

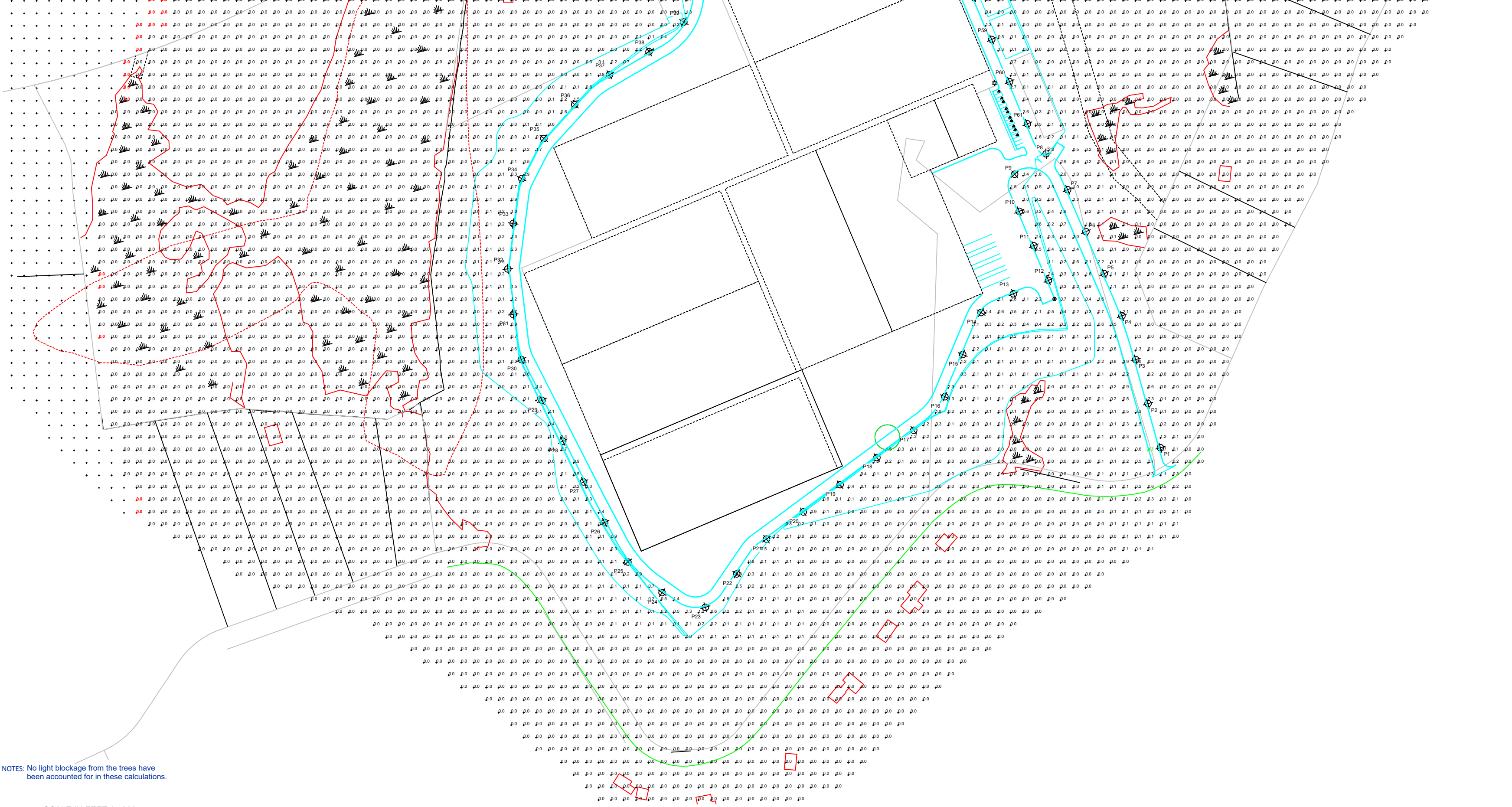

NOTES: No light blockage from the trees have been accounted for in these calculations.

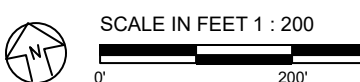

Pole location(s) ⊕ dimensions are relative to 0,0 reference point(s) ⊗



**EQUIPMENT LAYOUT**

**INCLUDES:**

· Drive / Parking Lot

**Electrical System Requirements:** Refer to Amperage Draw Chart and/or the "Musco Control System Summary" for electrical sizing.

**Installation Requirements:** Results assume ± 3% nominal voltage at line side of the driver and structures located within 3 feet (1m) of design locations.

**EQUIPMENT LIST FOR AREAS SHOWN**

QTY	LOCATION	Pole		Luminaires		QTY / POLE
		SIZE	GRADE ELEVATION	MOUNTING HEIGHT	LUMINAIRE TYPE	
1	P1	25'	-33'	2'	CREE OSQ 3000K (3ME)1	1
1	P2	25'	-23'	2'	CREE OSQ 3000K (3ME)1	1
2	P3, P17	25'	-16'	9'	CREE OSQ 3000K (3ME)1	2
1	P4	25'	-11'	14'	CREE OSQ 3000K (3ME)1	1
2	P5, P35	25'	1'	26'	CREE OSQ 3000K (3ME)1	2
1	P6	25'	11'	36'	CREE OSQ 3000K (3ME)1	1
2	P7, P24	25'	21'	46'	CREE OSQ 3000K (3ME)1	2
2	P8, P47	25'	27'	52'	CREE OSQ 3000K (4ME)1	2
1	P9	25'	33'	58'	CREE OSQ 3000K (4ME)2	1
1	P10	25'	27'	52'	CREE OSQ 3000K (4ME)2	1
1	P11	25'	19'	44'	CREE OSQ 3000K (4ME)2	1
1	P12	25'	9'	34'	CREE OSQ 3000K (4ME)1	1
1	P13	25'	8'	33'	CREE OSQ 3000K (4ME)2	1
1	P14	25'	6'	31'	CREE OSQ 3000K (3ME)1	1
1	P15	25'	-3'	22'	CREE OSQ 3000K (3ME)1	1
1	P16	25'	-19'	6'	CREE OSQ 3000K (3ME)1	1
1	P18	25'	-10'	15'	CREE OSQ 3000K (3ME)1	1
2	P19, P31	25'	-1'	24'	CREE OSQ 3000K (3ME)1	2
2	P20, P30	25'	3'	28'	CREE OSQ 3000K (3ME)1	2
2	P21, P23	25'	15'	40'	CREE OSQ 3000K (3ME)1	2
1	P22	25'	17'	42'	CREE OSQ 3000K (3ME)1	1
2	P25, P57	25'	24'	49'	CREE OSQ 3000K (3ME)1	2
3	P26-P27	25'	27'	52'	CREE OSQ 3000K (3ME)1	3
	P58					
2	P28, P50	25'	23'	48'	CREE OSQ 3000K (3ME)1	2
1	P29	25'	12'	37'	CREE OSQ 3000K (3ME)1	1
3	P32-P34	25'	-5'	20'	CREE OSQ 3000K (3ME)1	3
1	P36	25'	14'	39'	CREE OSQ 3000K (3ME)1	1
1	P37	25'	22'	47'	CREE OSQ 3000K (3ME)1	1
1	P38	25'	28'	53'	CREE OSQ 3000K (3ME)1	1
1	P39	25'	26'	51'	CREE OSQ 3000K (3ME)1	1
1	P40	25'	19'	44'	CREE OSQ 3000K (3ME)1	1
1	P41	25'	11'	36'	CREE OSQ 3000K (4ME)1	1
1	P42	25'	7'	32'	CREE OSQ 3000K (4ME)1	1
1	P43	25'	20'	45'	CREE OSQ 3000K (4ME)1	1
1	P44	25'	29'	54'	CREE OSQ 3000K (4ME)1	1
1	P45	25'	33'	58'	CREE OSQ 3000K (4ME)1	1
1	P46	25'	32'	57'	CREE OSQ 3000K (4ME)1	1
2	P48-P49	25'	17'	42'	CREE OSQ 3000K (4ME)1	2
1	P51	25'	38'	63'	CREE OSQ 3000K (4ME)1	1
1	P52	25'	49'	74'	CREE OSQ 3000K (4ME)1	1
1	P53	25'	50'	75'	CREE OSQ 3000K (4ME)1	1
1	P54	25'	46'	71'	CREE OSQ 3000K (4ME)1	1
1	P55	25'	37'	62'	CREE OSQ 3000K (4ME)1	1
1	P56	25'	25'	50'	CREE OSQ 3000K (3ME)1	1
1	P59	25'	32'	57'	CREE OSQ 3000K (3ME)1	1
1	P60	25'	39'	64'	CREE OSQ 3000K (3ME)1	1
1	P61	25'	31'	56'	CREE OSQ 3000K (4ME)1	1
61					TOTALS	65

**SINGLE LUMINAIRE AMPERAGE DRAW CHART**

Ballast Specifications (90 min power factor)	Line Amperage Per Luminaire (max draw)					
	208 (60)	220 (60)	240 (60)	277 (60)	347 (60)	480 (60)
Single Phase Voltage	208	220	240	277	347	480
Other	-	-	-	-	-	-

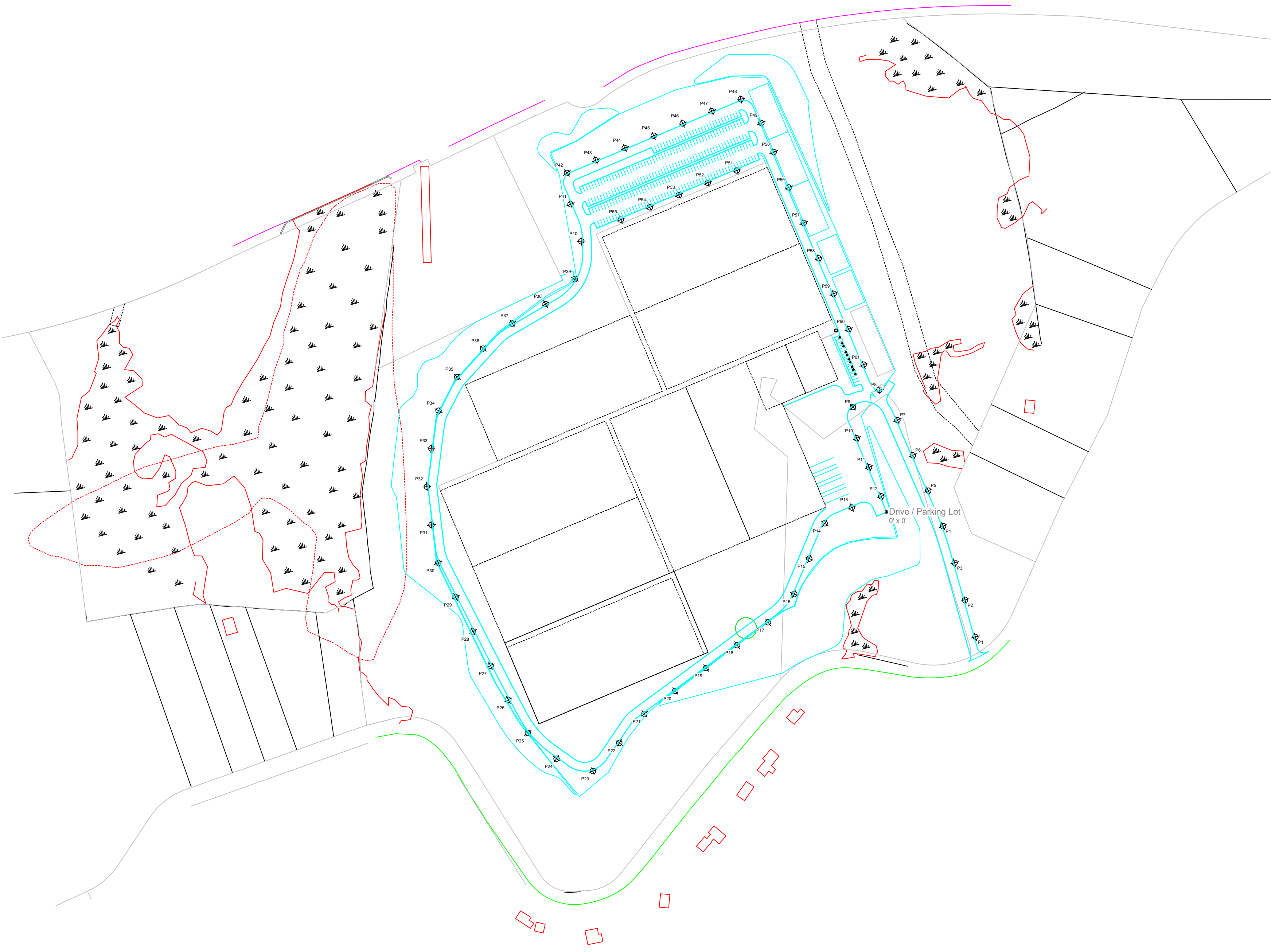

ENGINEERED DESIGN By: Nathan Chizek • File #194201A • 20-Aug-18

Pole location(s) + dimensions are relative to 0,0 reference point(s) ⊗



Not to be reproduced in whole or part without the written consent of Musco Sports Lighting, LLC. ©1981, 2018 Musco Sports Lighting, LLC.